

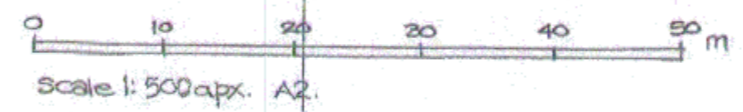



Project	Proposed Model Farm Scheme		
Location	Land at Sutton Grange Paddock Norton Upon Derwent		
Client	Mr D Tatham		
Drawing	Site Layout		
date	March 2014	drawing no.	5A
scale	1:500 apx after others	project no.	0003/1
drawn	MT	revision	
checked			

The proposed group of buildings will read in the landscape as an Estate 'model farm' typical of 19th Century Wolds practice. Hard landscaping will reflect this purpose and era.

THIS DRAWING SHOULD BE READ IN CONJUNCTION WITH THE DESIGN GUIDE for planning purposes only not to be worked to.



-  Listed Barn
-  Approved buildings
-  Proposed buildings.

Malcolm Tempest Ltd
 Architecture, Planning & Design
 HIGH PARKS, NEWTON-LE-WILLOWS
 BEDALE, NORTH YORKSHIRE, DL8 1TP
 Telephone: 01677 450777 Fax: 01677 450744

24.72 x 16.67

Project	Proposed Model Farm Scheme		
Location	Land at Sutton Grange Paddock Norton Upon Derwent		
Client	Mr D Tatham		
Drawing	Site Layout		
date	March 2014	drawing no.	5A
scale	1:500 apx after others	project no.	0003/1
drawn	MT	revision	
checked			

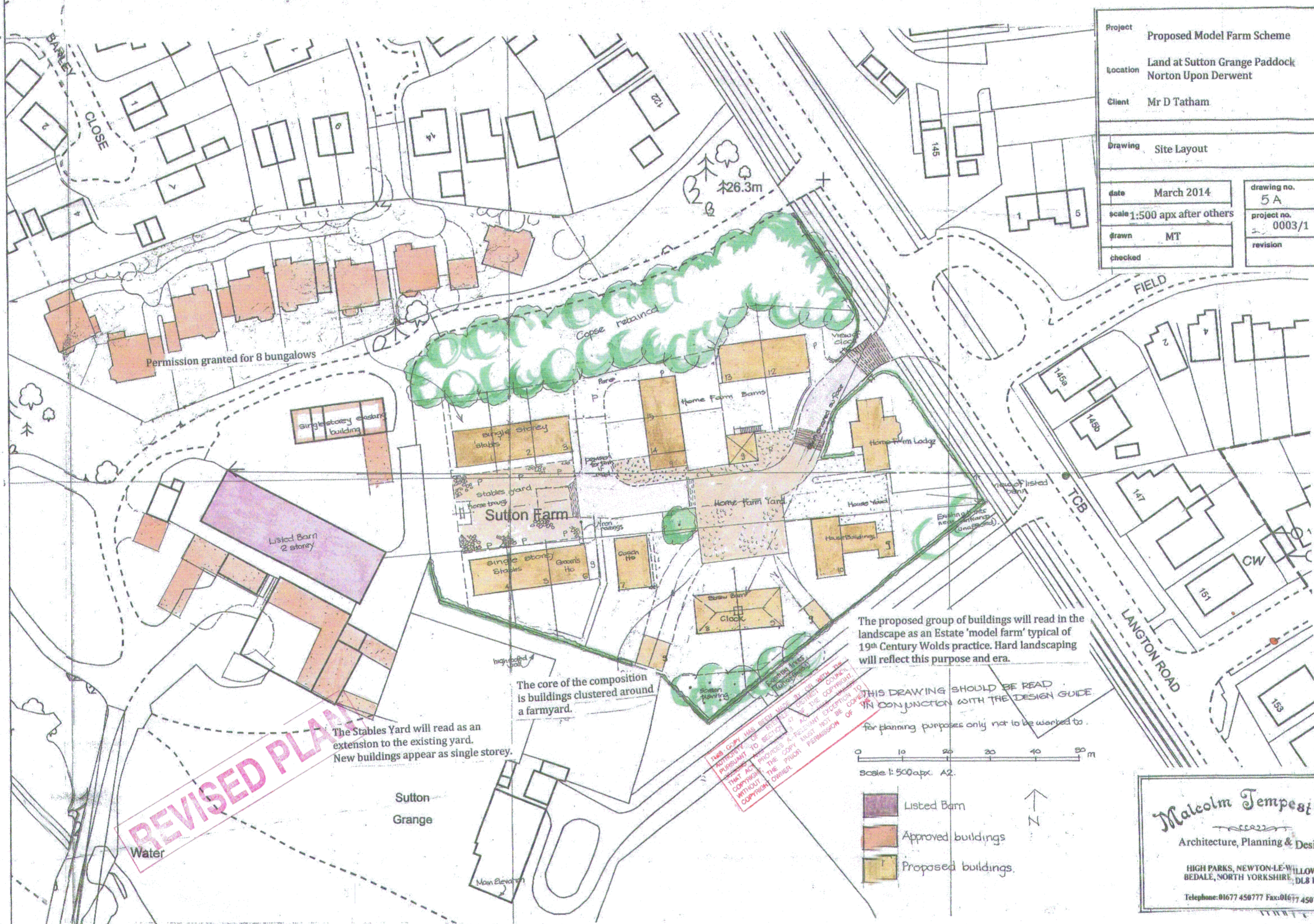

Permission granted for 8 bungalows

single storey extension building

Listed Barn 2 storey

Sutton Farm

Home Farm Barns

Home Farm Lodge

Home Farm Yard

single storey Stables

Coach Ho

Clock

House Buildings

The core of the composition is buildings clustered around a farmyard.

The Stables Yard will read as an extension to the existing yard. New buildings appear as single storey.

The proposed group of buildings will read in the landscape as an Estate 'model farm' typical of 19th Century Wolds practice. Hard landscaping will reflect this purpose and era.

THIS DRAWING SHOULD BE READ IN CONJUNCTION WITH THE DESIGN GUIDE

for planning purposes only not to be worked to.

Scale 1:500 apx. A2.

- Listed Barn
- Approved buildings
- Proposed buildings.

REVISED PLAN

Malcolm Tempest Ltd
 Architecture, Planning & Design
 HIGH PARKS, NEWTON-LE-WILLOWS
 BEDALE, NORTH YORKSHIRE, DL8 1TP
 Telephone: 01677 450777 Fax: 01677 450744